

IBM Aspera Faspex

Global person-to-person and project-based file delivery and exchange

Key benefits & capabilities

- 100% reliable, high-speed data delivery
 - Flexible options for collaborators to easily send or receive Faspex packages using their preferred clients
 - Large-scale global project-based file exchange within and outside the organization
 - Comprehensive security protects important project data in transit over the wire and at rest
 - Built-in server, user, workgroup and package management for easy administration
 - Monitor transfer progress and performance in near real-time
-

IBM® Aspera® Faspex™ is an easy-to-use, flexible, and secure web application for global file collaboration and exchange. It provides an intuitive, efficient way for individuals and groups to transfer files and directories at high-speed, regardless of size, transfer distance or network conditions

Person to person file exchange simplifies collaboration

With today's global teams, effective collaboration requires fast and efficient ways to share data between team members, especially as the size and number of files grows. Aspera Faspex facilitates an easy, high-speed exchange of large files and directories over a wide area network, making it ideal for projects that involve multiple teams exchanging big data across continents and around the world.

Through a web-based interface, collaborators can create and send files and folders bundled as Faspex packages to individuals or groups, whether they are within the organization or external partners. Aspera FASP® technology provides delivery at maximum speed, while enterprise-grade security features help ensure that only authorized people have access to the data. Capabilities like drop boxes for ad hoc content submission, mobile device support, and an automated desktop downloader help ensure that teams stay on top of content changes, especially for projects with tight deadlines.

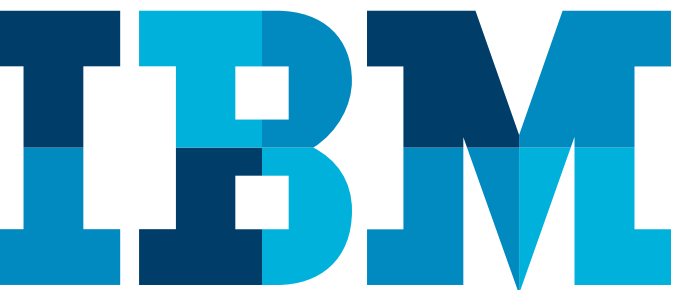

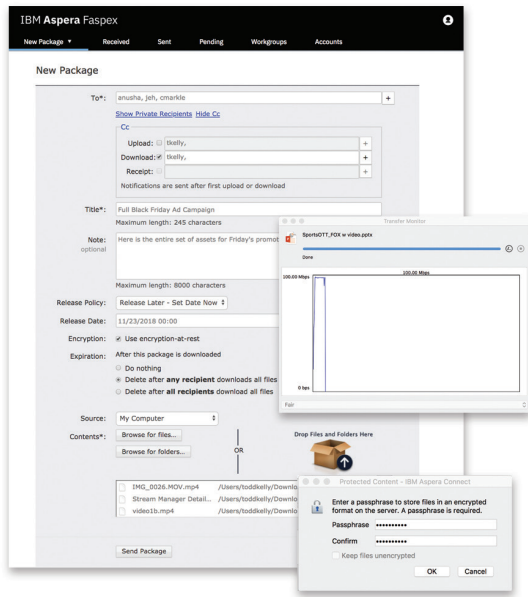

Figure 1: Views showing the creation of a Faspex package and progress of a Faspex transfer and download

Built on FASP for high-speed transfers

Aspera Faspex is powered by FASP, Aspera's unique, patented, high-speed bulk data transfer technology that transfers at maximum speed, fully utilizing the available bandwidth while remaining fair to other business-critical traffic. Entire directories can be delivered to recipients at a fraction of the time – up to thousands of times faster than with conventional network protocols. For cloud-based installations, on IBM Cloud, Amazon Web Services, Google Cloud Platform and Microsoft Azure, Aspera's Direct-to-S3 technology also optimizes the intra-cloud transfer rates, providing line-speed data movement along the entire path.

Powerful data management administration and automation

Aspera Faspex is built for enterprise-scale deployments, with encryption over the wire and at rest, LDAP integration, user authorization, group management, and metadata capture and enforcement. Multi-server and multi-site configurations, especially for geographically dispersed teams, provide better performance and reliability than conventional network protocols.

Key features

- High-speed FASP transfers regardless of file sizes, transfer distance or network conditions.
- Global digital data delivery and exchange using a standard browser, Outlook email client, or mobile devices.
- Browse any remote storage location and attach files or directories to a Faspex package.
- Drop boxes for ad hoc content submission from third parties with email invitation and notification.
- Self-registration for third parties with moderated and un-moderated configuration.
- LDAP directory services integration for user authentication and authorization.
- Full AES 128-bit data encryption available over the wire and at rest.
- Multi-server and multi-site configurations for improved performance and reliability.
- Available with IBM® Aspera® on Demand and Amazon Web Services as a subscription-based service.

Supported platforms

Server

- Linux
- Windows (2008, 2012, 2016)

Browsers

- Internet Explorer 9+, Microsoft Edge 39+, Firefox 27+, Safari 6+, Google Chrome 40+

Optional Aspera software

- IBM® Aspera® Drive
- IBM® Aspera® Console (management web app)
- IBM® Aspera® Mobile apps for iOS and Android
- IBM® Aspera® Cargo
- IBM® Aspera® Shares
- IBM® Aspera® Add-in for Microsoft® Outlook

Typical applications

Digital assets exchange

Secure transfer of files and folders of any size between users across the globe via desktops, laptops, tablets and smart phones.

Distributed team collaboration

Fast, efficient exchange of large files or entire project folders between distributed teams using a familiar email-style workflow.

Automated file distribution

Automated receipts of digital deliveries from multiple entities save time and hassle and reduce risk of file loss in a manual process.

Plug-in library highlights

Review approval and QA

- Customized drop boxes with metadata and triggers for automated post-receipt file processing.

Secure contribution from remote users and partners

- Custom user registration, including self-registration, for ad hoc submissions and distributions that do not require a Faspex account.

Features and benefits

Maximum data transfer performance

- Transfers are powered by FASP – packages are sent at high-speed, regardless of file sizes, transfer distance, or network conditions.
- Precise bandwidth control for maximum transfer speeds and fairness to other traffic.
- 100 percent reliable data delivery with automatic resumes of partial transfers, retries of failed transfers and fallback to HTTP for highly restrictive networks.
- Optimized cloud storage I/O achieves line-speed transfers along the entire path.
- Fast, lossless inline compression reduces data sizes, providing further speed boost.

Designed for fast, efficient collaboration

- Choice of interfaces for high-speed upload and download of Faspex packages: browser plug-in, desktop application, Microsoft Outlook add-in, and iOS mobile app.
- Advanced support for hybrid on premises and cloud content storage.
- Automatically forward workgroup or dropbox packages to multiple remote nodes.
- Interoperable with Aspera Drive, Shares, Cargo, Drive Mobile and Faspex Mobile.
- Remote source publishing (on-premises and cloud) allows users to search and browse any remote storage location and attach files or directories to send in a Faspex package.
- Perform file validation “out-of-transfer,” which allows for post-transfer processing to begin immediately after a file transfer
- Private drop boxes for content contribution with tracking and notifications.
- Self-registration for third parties with moderated and un-moderated configuration

Secure and reliable enterprise-grade platform

- Enhanced SAML support with just in time provisioning of Faspex users on SAML login.
- Automatic expiration of Faspex user accounts based on a configurable period of inactivity.
- Integrated with LDAP directory services for import, synchronization, direct authentication, and secure authentication, scalable to thousands of users.
- Full AES-128 data encryption available over the wire and at rest.
- Option for Active / Active HA cluster configuration with shared storage.

Custom workflow integrations

- Enforceable custom metadata submission requirements and metadata validation.
- Automatic triggering of post-processing functions after upload completion.
- Custom programmatic integrations via a command line tool or a web services API.

About IBM Aspera

IBM Aspera offers next-generation transport technologies that move the world's data at maximum speed regardless of file size, transfer distance and network conditions. Based on its patented, Emmy® award-winning FASP® protocol, Aspera software fully utilizes existing infrastructures to deliver the fastest, most predictable file-transfer experience. Aspera's core technology delivers unprecedented control over bandwidth, complete security and uncompromising reliability. Organizations across a variety of industries on six continents rely on Aspera software for the business-critical transport of their digital assets.

For more information

On IBM Aspera solutions, please visit us at <https://www.ibm.com/cloud/high-speed-data-transfer> or contact aspera-sales@ibm.com.



© Copyright IBM Corporation 2018

IBM Corporation
Route 100
Somers, NY 10589

Produced in the United States of America
November 2018

IBM, the IBM logo, ibm.com and Aspera are trademarks or registered trademarks of International Business Machines Corporation in the United States, other countries, or both. If these and other IBM trademarked terms are marked on their first occurrence in this information with a trademark symbol (® or ™), these symbols indicate U.S. registered or common law trademarks owned by IBM at the time this information was published. Such trademarks may also be registered or common law trademarks in other countries. A current list of IBM trademarks is available on the Web at "Copyright and trademark information" at: ibm.com/legal/us/en/copytrade.shtml

Linux is a registered trademark of Linus Torvalds in the United States, other countries, or both.

Microsoft, Windows, Windows NT, and the Windows logo are trademarks of Microsoft Corporation in the United States, other countries, or both.

Other product, company or service names may be trademarks or service marks of others.

This document is current as of the initial date of publication and may be changed by IBM at any time. Not all offerings are available in every country in which IBM operates.

The performance data and client examples cited are presented for illustrative purposes only. Actual performance results may vary depending on the specific configurations and operating conditions. It is the user's responsibility to evaluate and verify the operation of any other products or programs with IBM product and programs. THE INFORMATION IN THIS DOCUMENT IS PROVIDED "AS IS" WITHOUT ANY WARRANTY, EXPRESS OR IMPLIED, INCLUDING WITHOUT ANY WARRANTIES OF MERCHANTABILITY, FITNESS FOR A PARTICULAR PURPOSE AND ANY WARRANTY OR CONDITION OF NON-INFRINGEMENT. IBM products are warranted according to the terms and conditions of the agreements under which they are provided.



Please Recycle
